

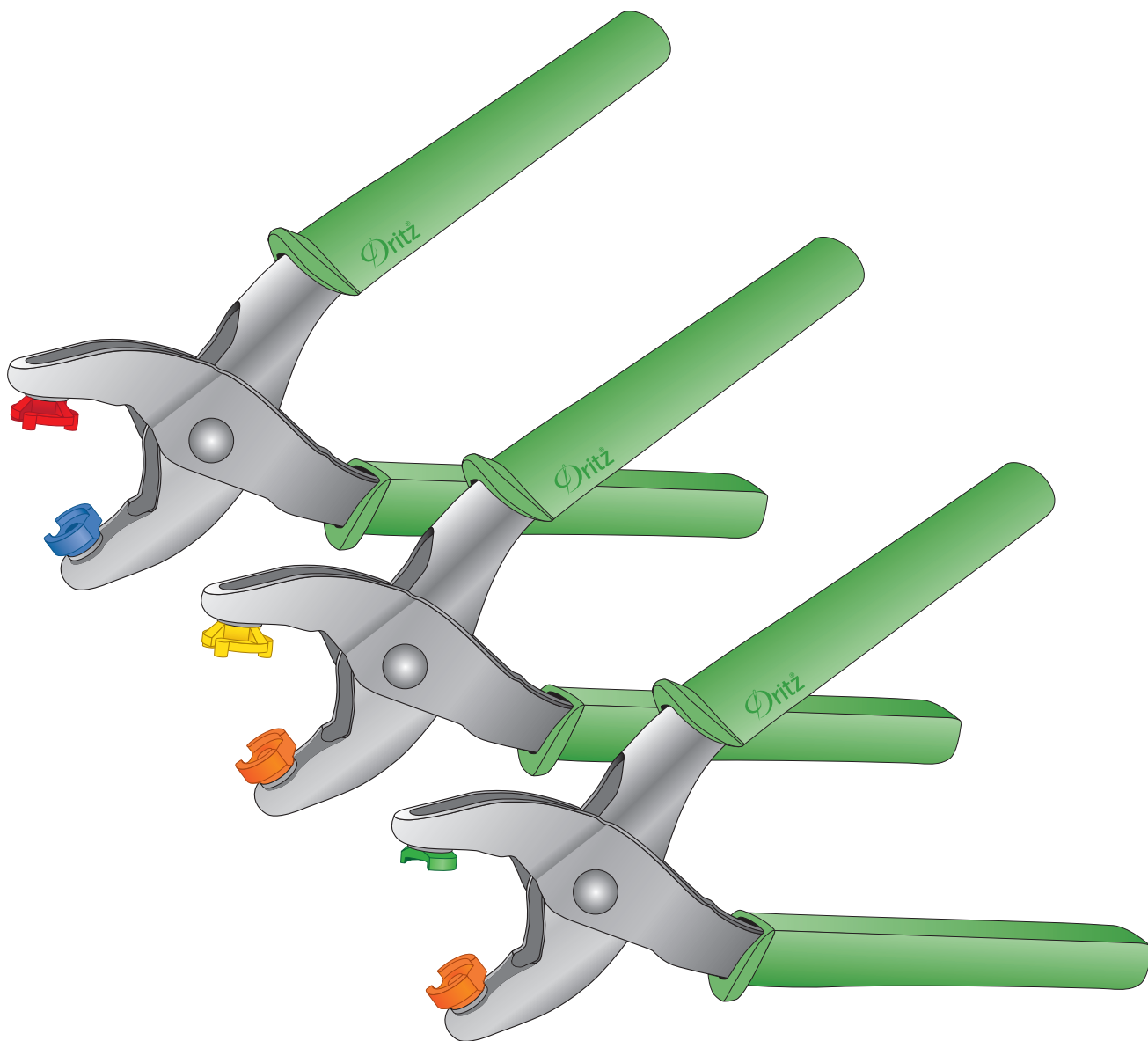

16P SNAP PLIERS

Instruction Guide for
3/8" & 7/16" Open-Ring Snaps
7/16" Pearl Snaps



16P SNAP PLIERS – 3/8" Open-Ring Snap Instructions

Fabric Preparation for 3/8" Open-Ring Snaps

Use two layers of light to medium-weight fabric, reinforced with interfacing. Mark position of snaps on topside and underside of garment. Test a snap on swatch of fabric.

Instructions for Applying 3/8" Open-Ring Snaps

Snap Parts:

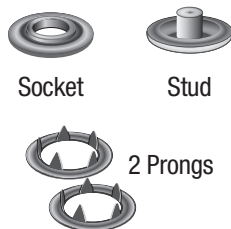

Pliers Tools:

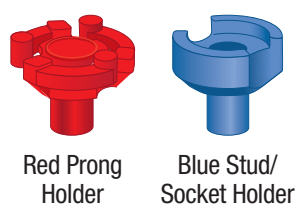

Inserting Tools:

Insert red prong holder in one side of pliers and blue stud/ socket holder in other side.

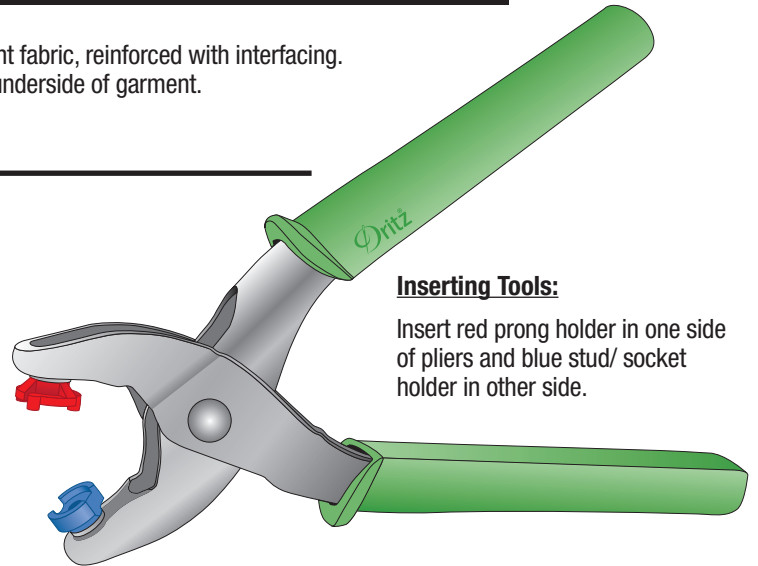

Applying Socket (*Topside of garment*):

1. Position prong, *point side out*, in red prong holder. Position socket, *raised center out*, in blue stud/socket holder.

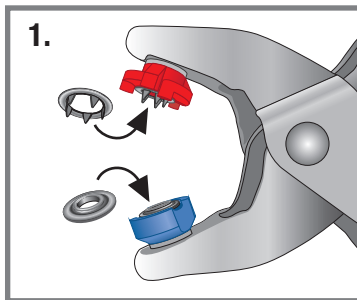

2. Position topside of garment in pliers with snap prong on the right side of the garment. Center over marked position.

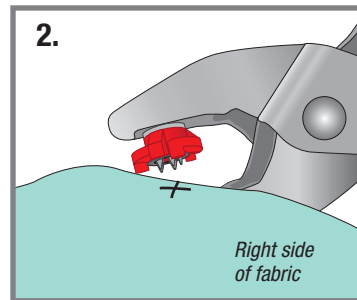

3. Squeeze pliers firmly to apply snap. Check for tightness; squeeze again, if necessary.

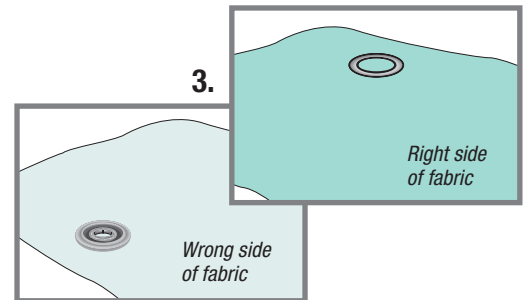

Applying Stud (*Underside of garment*):

1. Position prong, *point side out*, in red prong holder. Position stud, *ball side down*, in blue stud/socket holder.

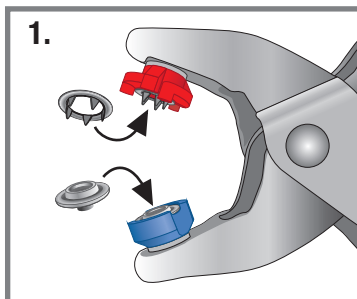

2. Position underside of garment in pliers with prong on the wrong side of garment. Center over marked position.

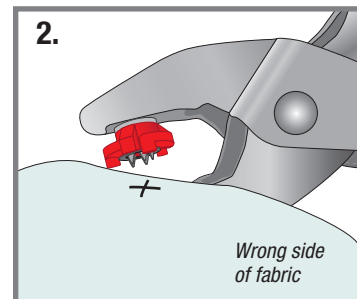

3. Squeeze pliers firmly to apply snap. Check for tightness; squeeze again, if necessary.

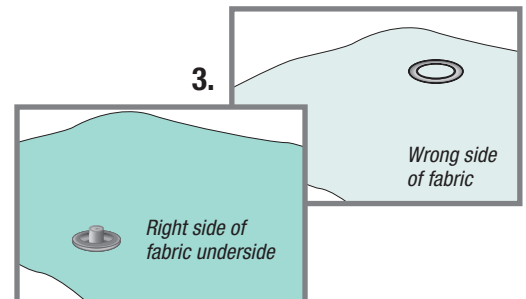

Removing Tools:

Slip hook of gray tool remover inside ledge of pliers and press down to release tool.

Repeat for opposite side.

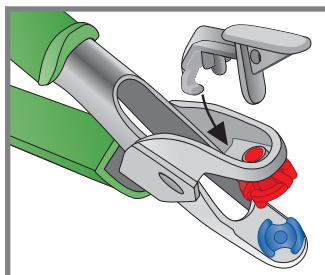

16P SNAP PLIERS – 7/16" Open-Ring Snap Instructions

Fabric Preparation for 7/16" Open-Ring Snaps

Use two layers of light to medium-weight fabric, reinforced with interfacing. Mark position of snaps on topside and underside of garment. Test a snap on swatch of fabric.

Instructions for Applying 7/16" Open-Ring Snaps

Snap Parts:

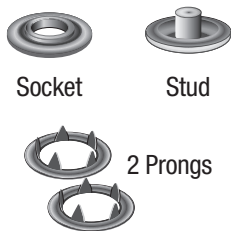

Pliers Tools:

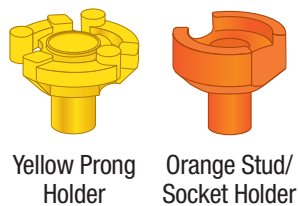

Inserting Tools:

Insert yellow prong holder in one side of pliers and orange stud/socket holder in other side.

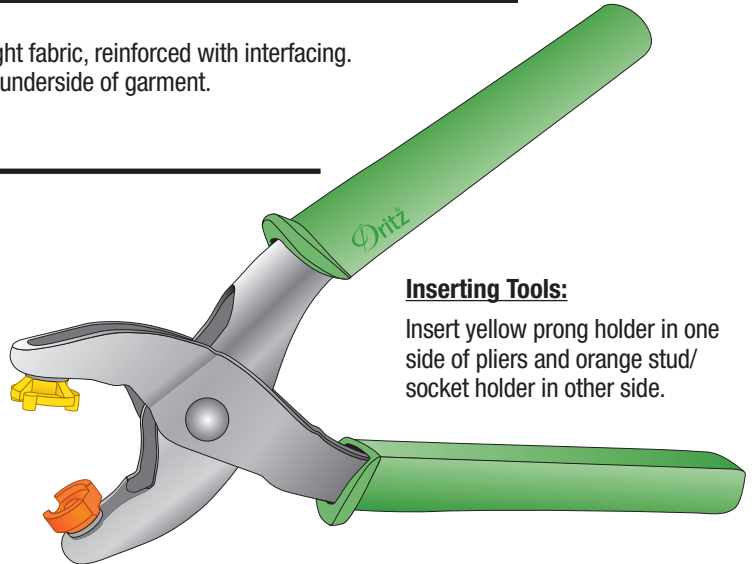

Applying Socket (*Topside of garment*):

1. Position prong, *point side out*, in yellow prong holder. Position socket, *raised center out*, in orange stud/socket holder.
2. Position topside of garment in pliers with snap prong on the right side of the garment. Center over marked position.
3. Squeeze pliers firmly to apply snap. Check for tightness; squeeze again, if necessary.

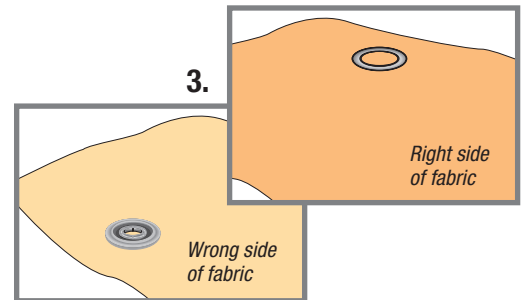
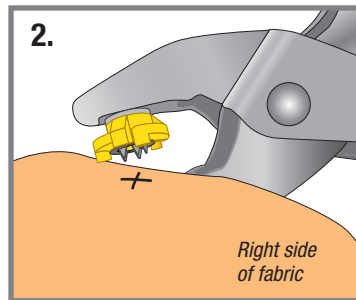
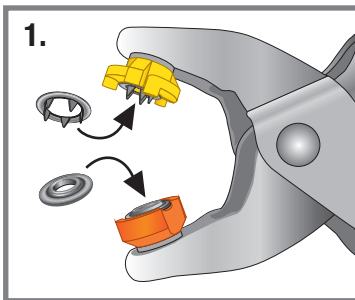

Applying Stud (*Underside of garment*):

1. Position prong, *point side out*, in yellow prong holder. Position stud, *ball side down*, in orange stud/socket holder.
2. Position underside of garment in pliers with prong on the wrong side of garment. Center over marked position.
3. Squeeze pliers firmly to apply snap. Check for tightness; squeeze again, if necessary.

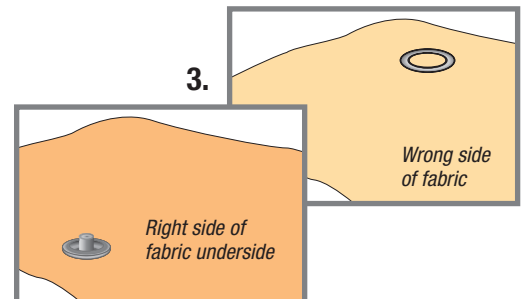
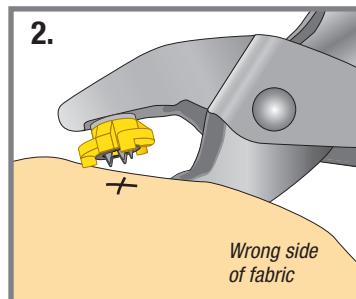
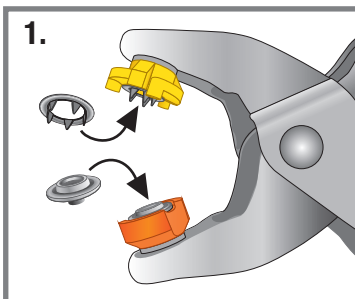

Removing Tools:

Slip hook of gray tool remover inside ledge of pliers and press down to release tool.

Repeat for opposite side.

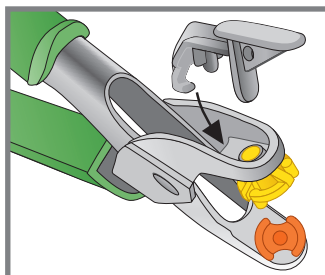

16P SNAP PLIERS – 7/16" Pearl Snap Instructions

Fabric Preparation for 7/16" Pearl Snaps

Use two layers of light to medium-weight fabric, reinforced with interfacing. Mark position of snaps on topside and underside of garment. Test a snap on swatch of fabric.

Instructions for Applying 7/16" Pearl Snaps

Snap Parts:

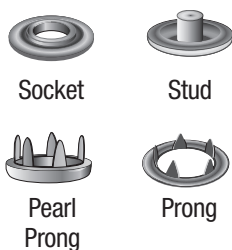

Pliers Tools:

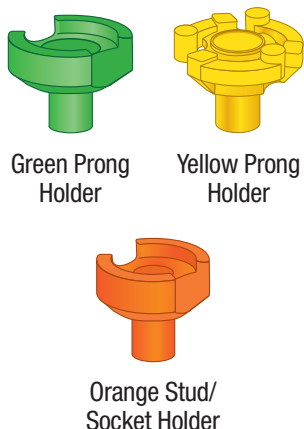

Inserting Tools:

Insert orange stud/socket holder in one side of pliers.

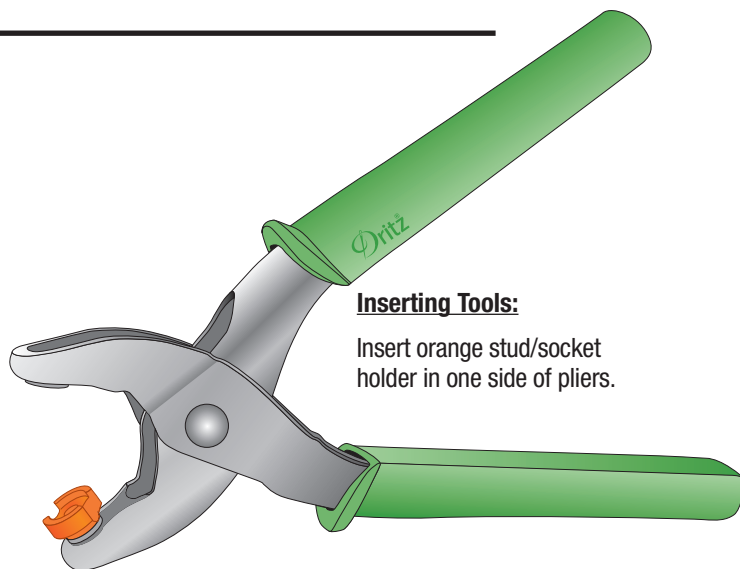

Applying Socket (Topside of garment):

1. Insert green pearl prong holder in other side of pliers.

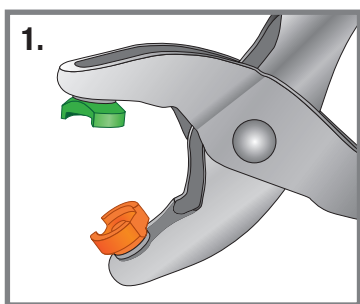

2. Position pearl prong, *point side out*, in green pearl prong holder. Position socket, *raised center out*, in orange stud/socket holder.

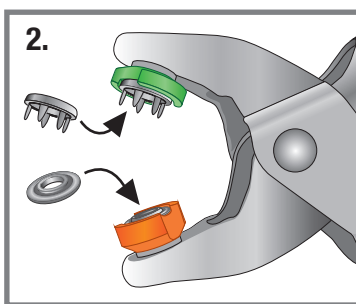

3. Position topside of garment in pliers with snap prong on the right side of the garment. Center over marked position.

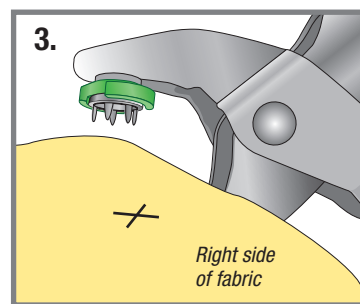

4. Squeeze pliers firmly to apply snap. Check for tightness; squeeze again, if necessary.

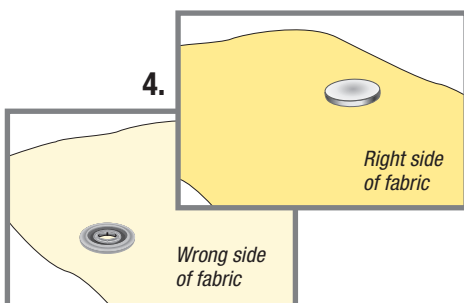

5. Remove green pearl prong holder after applying all pearl prongs. Slip hook of gray tool remover inside ledge of pliers and press down to release tool.

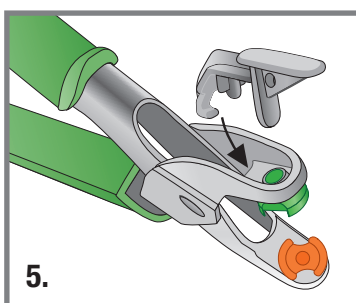

16P SNAP PLIERS – 7/16" Pearl Snap Instructions (cont.)

Applying Stud (Underside of garment):

1. Insert yellow prong holder in other side of pliers. (Orange stud/socket holder remains in opposite side of pliers.)

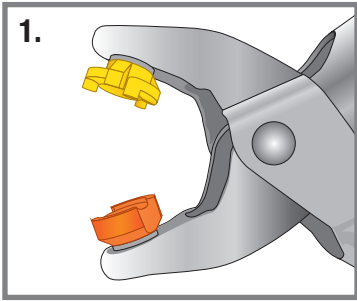

2. Position prong, *point side out*, in yellow prong holder. Position stud, *ball side down*, in orange stud/socket holder.

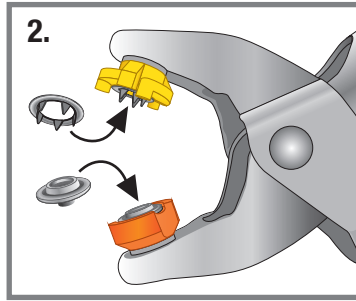

3. Position underside of garment in pliers with prong on the wrong side of garment. Center over marked position.

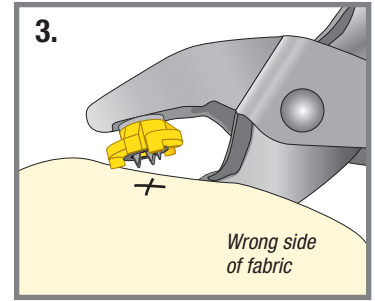

4. Squeeze pliers firmly to apply snap. Check for tightness; squeeze again, if necessary.

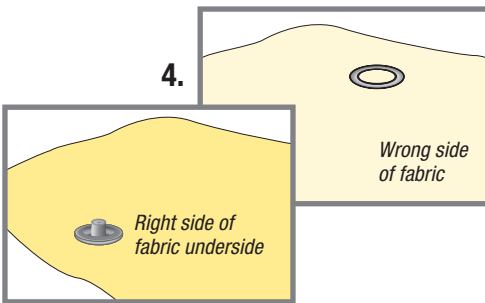

Removing Tools:

Slip hook of gray tool remover inside ledge of pliers and press down to release tool.

Repeat for opposite side.

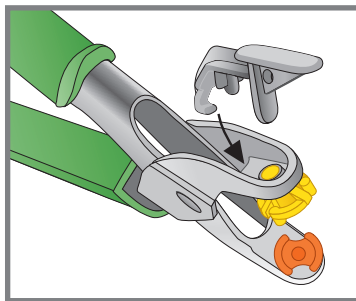

Additional Information

Storing Pliers

Squeeze pliers together and hook gray tool remover at top of pliers.

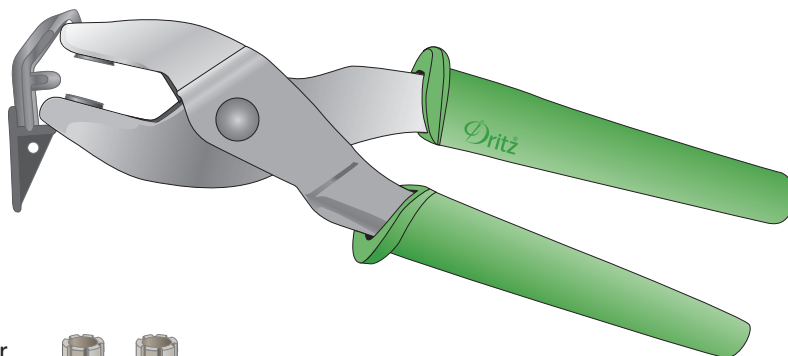

Replacement Inserts

Replacement inserts have been provided. When tools are no longer staying in pliers well, remove worn insert and replace with new.

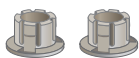

WARNING: CHOKING HAZARD – SMALL PARTS. Keep away from children under 3.